

### BU-1420711871

(CONN SMA JACK STR 50 OHM EDGE MOUNT)

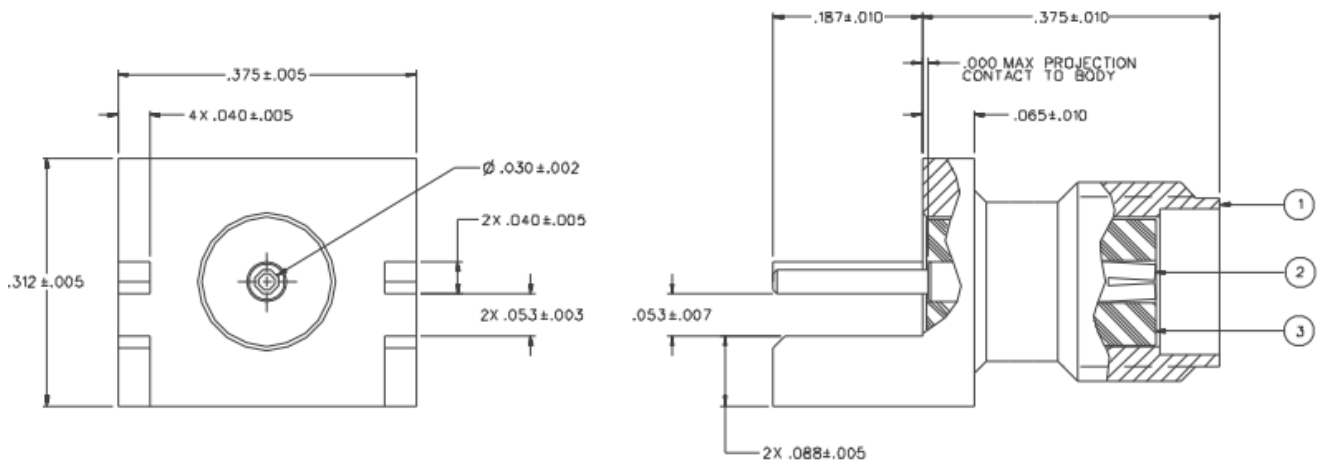
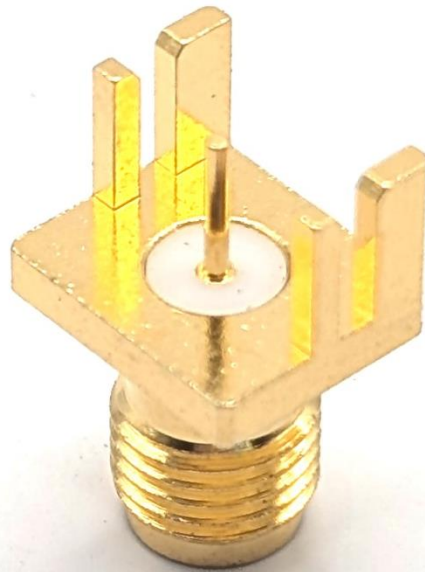

(Dimensions in Inches)

- Impedance: 50 Ohms
- Frequency Range: 0-18 GHz
- Working Voltage: 335V at Sea Level
- Dielectric Withstanding Voltage: 1000V min at sea level
- Contact resistance: <3 milliohms
- Mating Torque: 7-10 Inch Pounds
- Material:
  - (1) Body – 1U” Gold plated Brass
  - (2) Contact – 5U” Gold plated Beryllium Copper
  - (3) Insulator – Teflon
- Meets or Exceeds the applicable paragraph of MIL-C-39012
- Operating Temperature: -65°C (-85°F) to 165°C (329°F)
- RoHS 3 Compliant