

LOC	DIST	REVISIONS					
		P	LTR	DESCRIPTION	DATE	DWN	APVD
CM	00		A	RELEASED PER WR-07-123	25SEP2007	KW	DC
			A1	REVISED PER ECR-21-119230	08NOV2021	SS	VS

1. PARTS COMPLY TO AMP SOLDERABILITY SPECIFICATION 109-11-2.
2. CIRCUIT IDENTIFICATION CHARACTERS ARE ADJACENT TO THE INDICATED CAVITIES, BUT LOCATION AND ORIENTATION MAY DIFFER FROM PRINT.
3. DIMENSIONS SHOWN REPRESENT PRODUCT IN DRY CONDITION. ADDITIONAL 2% GROWTH DUE TO END USE LOCATION MOISTURE ABSORPTION MAY OCCUR AND SHOULD BE ACCOUNTED FOR.

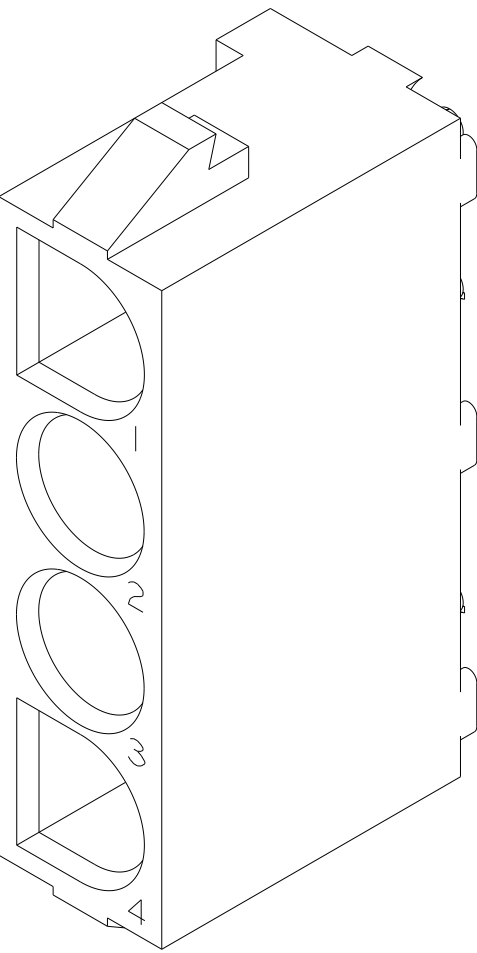

3 DIMENSIONAL MODEL
SCALE 4:1

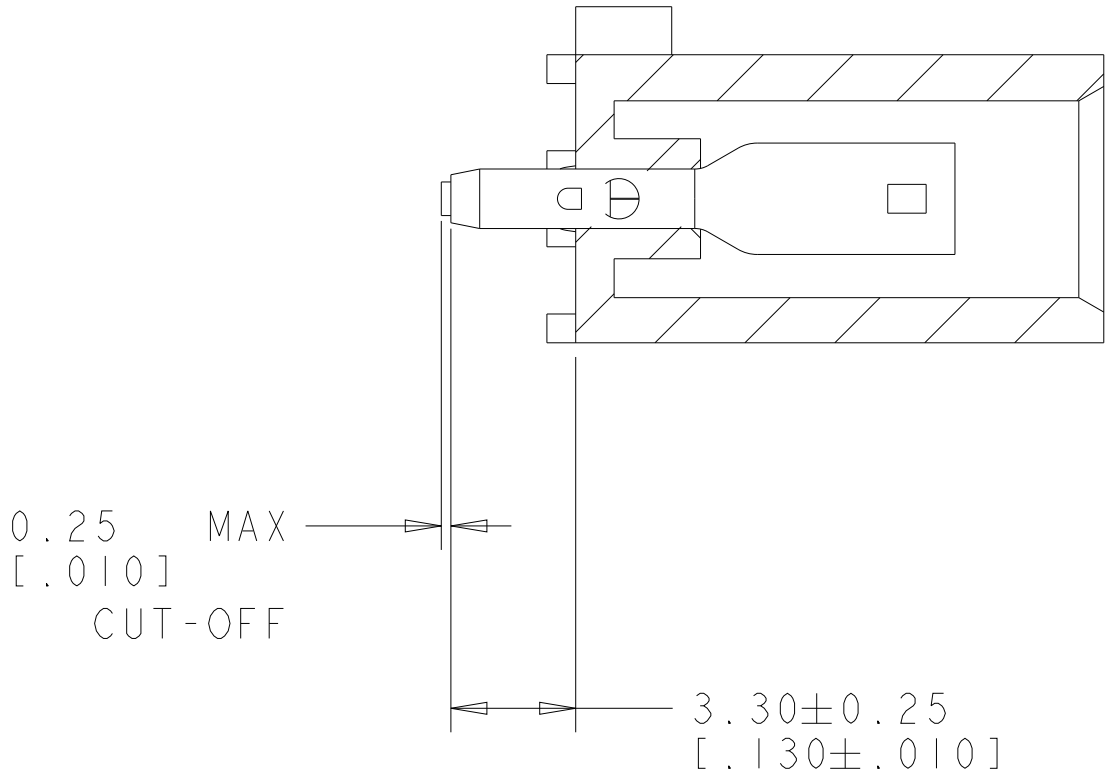
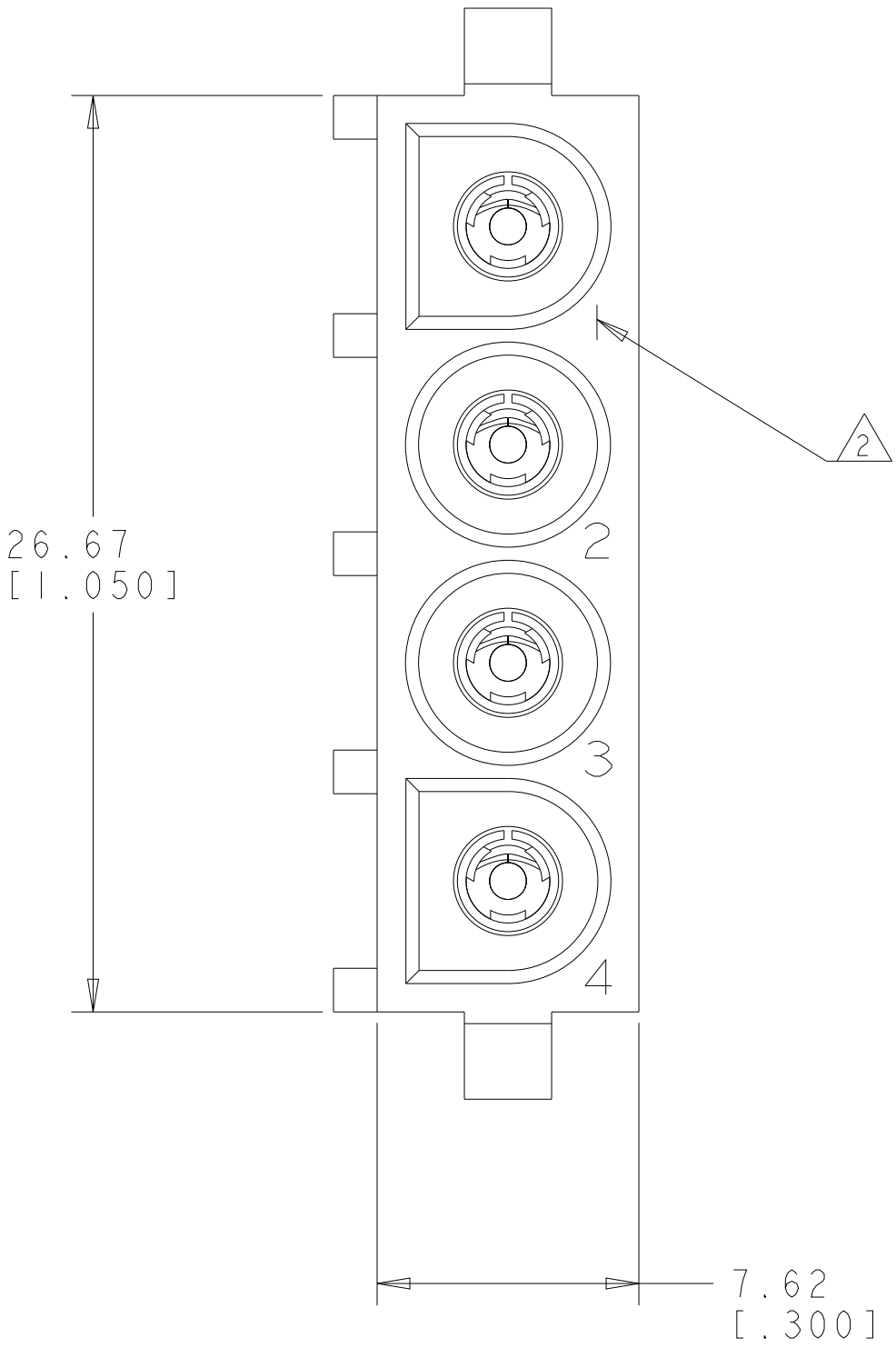
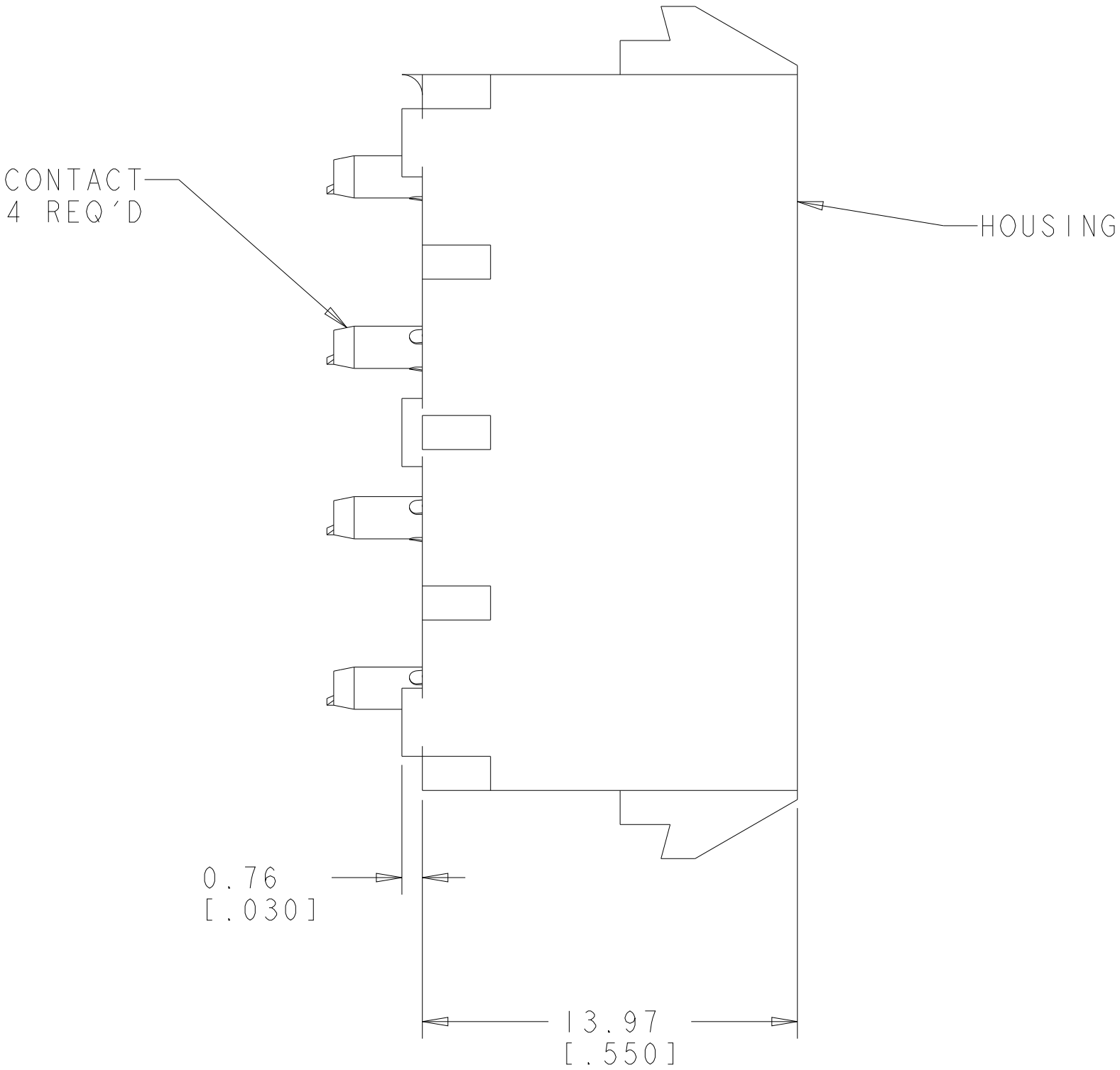
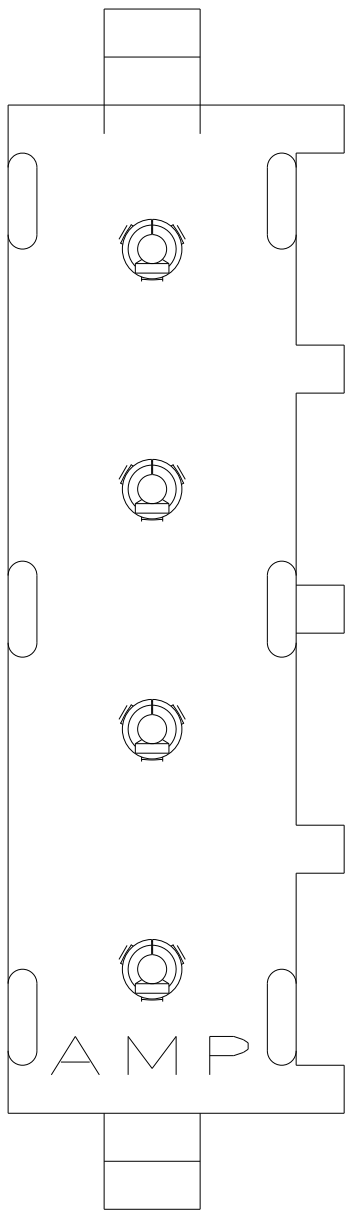
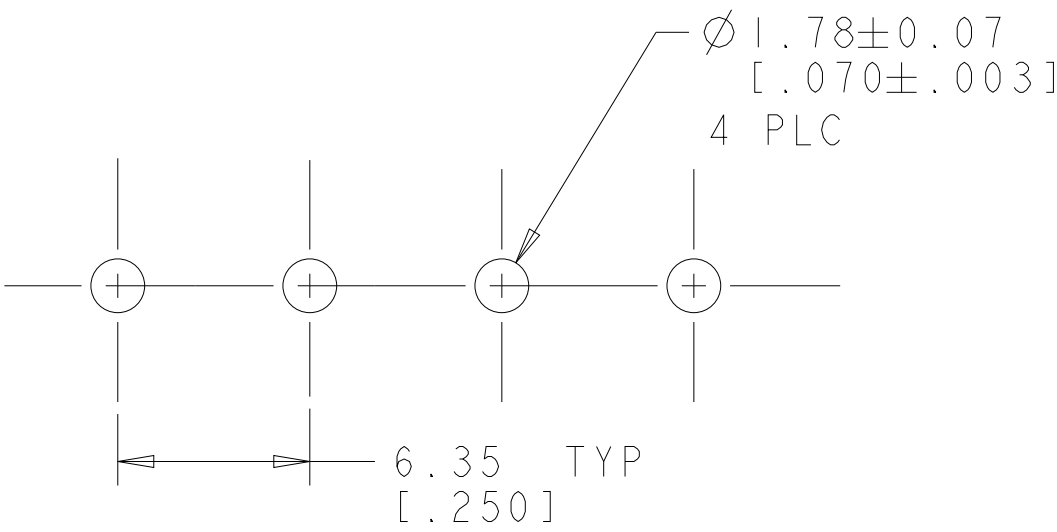

RECOMMENDED MOUNTING HOLE PATTERN
FOR 1.57 [.062] THICK P.C. BOARD

PHOSPOR BRONZE, PRE-TIN	NYLON, UL94V-0, NATURAL	2029001-1
PIN CONTACT MATERIAL AND FINISH	HOUSING MATERIAL AND COLOR	PART NUMBER

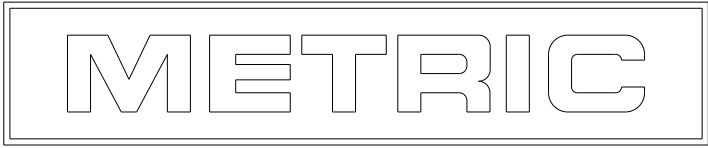

THIS DRAWING IS A CONTROLLING DOCUMENT FOR TYCO ELECTRONICS CORPORATION. IT IS THE POLICY OF TYCO ELECTRONICS CORPORATION TO CONTROL THE DESIGNING ORGANIZATION. SHOULD BE CONTACTED FOR THE LATEST EDITION.		DWN K. WHITAKER 25SEP2007	Tyco Electronics Harrisburg, PA 17105-3608		
DIMENSIONS: mm[INCHES]		CHK D. COLEY 25SEP2007	NAME		
TOLERANCES UNLESS OTHERWISE SPECIFIED:		APVD D. COLEY 25SEP2007	PRODUCT SPEC SOCKET HEADER ASSEMBLY, 4 CIRCUIT, SHORT TAIL, UNIVERSAL MATE-N-LOK(TM)		
0 PLC ±"		APPLICATION SPEC			
1 PLC ±"		WEIGHT			
2 PLC ±0.13(.005)		SIZE			
3 PLC ±"		CAGE CODE			
4 PLC ±"		DRAWING NO			
ANGLES ±0°30'		RESTRICTED TO			
FINISH		CUSTOMER DRAWING			
MATERIAL		SCALE			
SEE TABLE		SHEET			
		OF			
		REV			